



PACIFIC BUSINESS CENTER

BUILDING SHELL

LOUISE AVENUE

MANTECA, CALIFORNIA

PLANNING SUBMITTAL
SNR10-0027-00

WARE MALCOMB
Leading Design for Commercial Real Estate

architecture
planning
interiors
graphics
civil engineering

2400 camino ramon, suite 390
san ramon, california 94583
phone: (925) 244-9620
fax: (925) 244-9621

VICINITY MAP

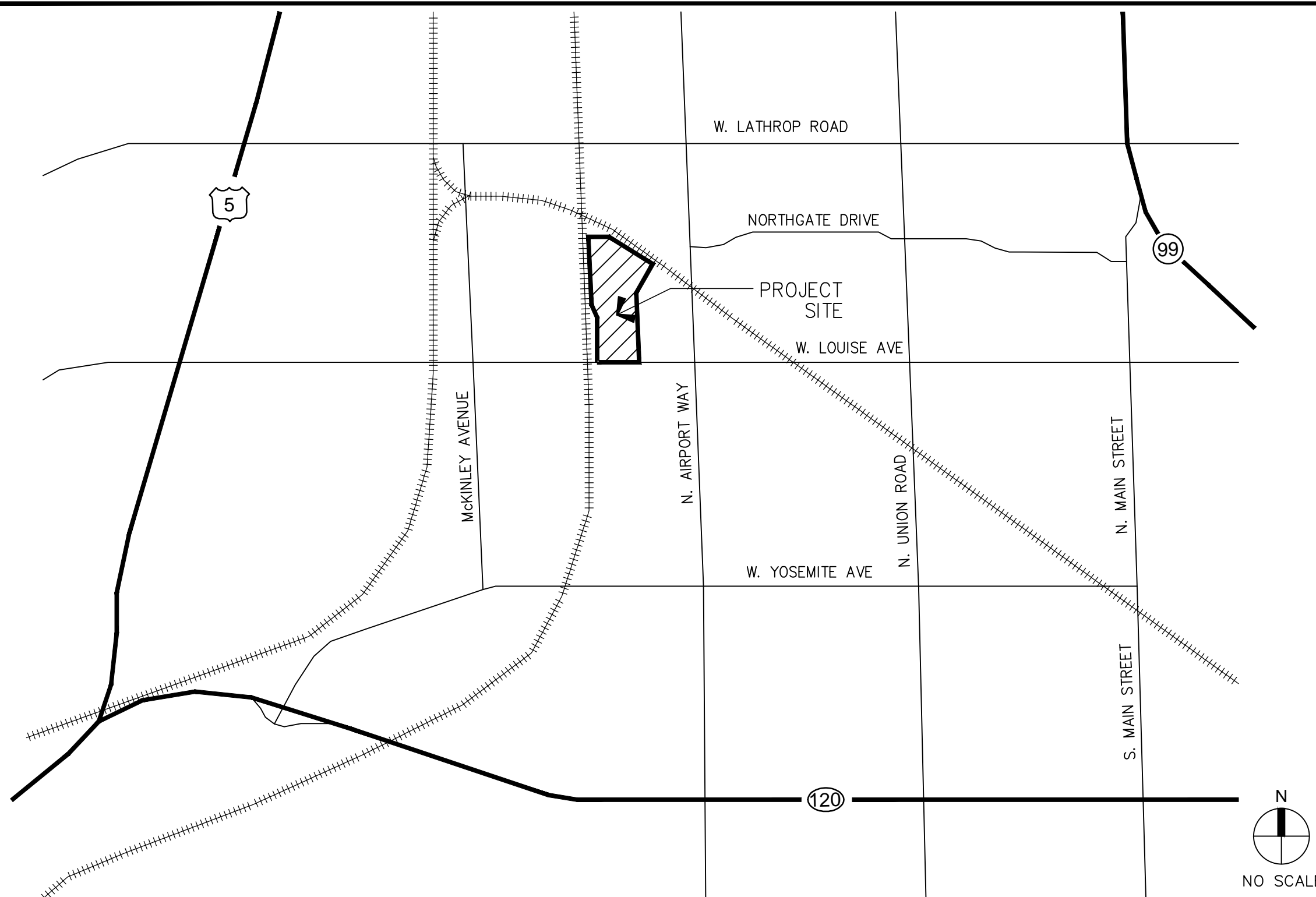

PROJECT TEAM

CLIENT

WESTCORE PROPERTIES

2658 BRIDGEWAY, SUITE 100 SAUSAITO, CA 94965 PH: (415) 331-5900

APPLICANT

OAC CONSULTING

WILLIAM HALL PH: (858) 382-0391

ARCHITECT/CIVIL ENGINEER

WARE MALCOMB

2400 CAMINO RAMON, SUITE 390 SAN RAMON, CA 94583 ANTHONY CATALDO PH: (925) 244-9620 FAX: (925) 244-9621

CONSULTANTS

CIVIL ENGINEER

KIER & WRIGHT CIVIL ENGINEERS 2850 COLLIER CANYON ROAD LIVERMORE, CA 94551

CHUCK McCALLUM PH: (925) 245-8788 FAX: (925) 245-8796

LANDSCAPE ARCHITECT

CALLA LANDSCAPE ARCHITECTS, INC. 2580 COUNTRY LANE AUBURN, CA 95603

ANGELA LONG PH: (530) 889-0377 FAX: (530) 889-0397

SHEET INDEX

ARCHITECTURAL DRAWINGS

- A0.1 TITLE SHEET
- A1.1 SITE PLAN
- A1.2 ENLARGED SITE PLAN
- A2.1 OVERALL FLOOR PLAN
- A2.1a PARTIAL FLOOR PLAN
- A2.1b PARTIAL FLOOR PLAN
- A2.1c PARTIAL FLOOR PLAN
- A2.1d PARTIAL FLOOR PLAN
- A2.1e PARTIAL FLOOR PLAN
- A2.1f PARTIAL FLOOR PLAN
- A2.1f PARTIAL FLOOR PLAN
- A3.1 ROOF PLAN
- A4.1 EXTERIOR ELEVATIONS
- A4.2 EXTERIOR ELEVATIONS
- A5.1 BUILDING SECTIONS
- PHM SITE PHOTOMETRICS

LANDSCAPE DRAWINGS

- L-1 PLANTING PLAN
- L-2 PLANTING DETAILS

CIVIL DRAWINGS

- C1 TOPOGRAPHIC SURVEY
- C2 PRELIMINARY GRADING AND DRAINAGE PLAN
- C3 EXISTING STORM DRAIN BASIN
- C4 PRELIMINARY UTILITY PLAN
- C5 EROSION CONTROL PLAN
- C6 STORM WATER QUALITY CONTROL PLAN

PROJECT DESCRIPTION

WESTCORE PROPERTIES IS DEVELOPING A NEW 939,660 SQUARE FOOT DISTRIBUTION BUILDING SHELL. THE SITE, CURRENTLY UNDEVELOPED, SHALL BE DEVELOPED AS PART OF AN EXISTING BUSINESS CENTER. THE SITE HAS BEEN ENHANCED WITH NUMEROUS NEW TREES AND LANDSCAPED AREAS. THE PROJECT WILL INCORPORATE LANDSCAPE FEATURES TO CREATE AN AESTHETICALLY PLEASING ENVIRONMENT THAT COMPLEMENTS THE EXISTING BUSINESS CENTER AND SERVE AS STORM WATER POLLUTION PREVENTION. PARKING STALLS PROVIDE A TOTAL OF 493 CAR STALLS (0.5 STALLS PER 1,000 SF) AND 276 TRUCK STALLS.

THE BUILDING IS A ONE-STORY CONCRETE TILT-UP CONSTRUCTION WITH HIGH PERFORMANCE GLAZING AND A COLOR PALETTE THAT WILL COMPLEMENT THE EXISTING BUSINESS CENTER. THE BUILDING WILL INCORPORATE A LOADING TRUCKWELL ON THE EAST AND WEST SIDES OF THE BUILDING.

PACIFIC BUSINESS CENTER
MANTECA, CALIFORNIA

TITLE SHEET		REMARKS	DATE	REMARKS
1	DATE	05/17/12	PLANNING SUBMITTAL	

PA / PM: RAYMOND LEE
DRAWN BY: LP
JOB NO.:

SHEET
A0.1

THESE DRAWINGS AND SPECIFICATIONS ARE THE PROPERTY AND COPYRIGHT OF WARE MALCOMB AND SHALL NOT BE USED ON ANY OTHER WORK EXCEPT BY AGREEMENT WITH WARE MALCOMB. WRITTEN DIMENSIONS SHALL TAKE PRECEDENCE OVER SCALED DIMENSIONS AND SHALL BE VERIFIED ON THE JOB SITE. ANY DISCREPANCY SHALL BE BROUGHT TO THE NOTICE OF WARE MALCOMB PRIOR TO THE COMMENCEMENT OF ANY WORK.