

KAISER PERMANENTE MANTECA - CN4901

SOLAR PHOTOVOLTAIC INSTALLATION
1777 WEST YOSEMITE AVENUE
MANTECA, CALIFORNIA 95337

PLANNING AND ZONING SUBMITTAL
JULY 17, 2017

NOTICE:

THIS RECORD DOCUMENT HAS BEEN PREPARED IN PART, BASED UPON INFORMATION FURNISHED BY OTHERS. WHILE THIS INFORMATION IS BELIEVED TO BE RELIABLE, ADM GROUP, INC. AND ITS CONSULTANTS CANNOT ASSURE ITS ACCURACY AND, THUS, ARE NOT RESPONSIBLE FOR THE ACCURACY OF THIS RECORD DOCUMENT OR FOR ANY ERRORS OR OMISSIONS WHICH MAY HAVE BEEN INCORPORATED INTO IT AS A RESULT. USER OF THIS DOCUMENT IS CAUTIONED TO CONDUCT PROPER FIELD VERIFICATION AS NECESSARY

PROJECT INFORMATION

CLIENT: KAISER PERMANENTE
PROJECT ADDRESS: 1777 W YOSEMITE AVENUE
MANTECA, CALIFORNIA 95337

CONSULTANTS

ARCHITECT: ADM GROUP, INC.
2100 W. 15TH STREET
TEMPE, ARIZONA 85281

PHONE: 480.285.3800

CONSULTANTS: LANDSCAPE
DESERT ADAPTIVE LANDSCAPE ARCHITECTURE
1900 W. CHANDLER BLVD., #15-362
CHANDLER, AZ 85224
602.369.1597

SHEET INDEX

ARCHITECTURAL	A0.0	PROJECT INFORMATION SHEET & OVERALL SITE PLAN
	A1.0	ENLARGED SITE PLAN
LANDSCAPE	L0.1	LANDSCAPE TREE DEMOLITION PLAN
	L1.1	LANDSCAPE PLAN
	L1.2	LANDSCAPE AND IRRIGATION NOTES PLAN
ELECTRICAL	E-PH1.0	ENLARGED SITE PLAN PHOTOMETRICS

CODE INFORMATION

AHJ: CITY OF MANTECA
USE GROUP: U (SOLAR PHOTOVOLTAIC PANELS SUPPORTED BY A STRUCTURE OVER PARKING STALLS)
CONSTRUCTION TYPE: IIB
ASSESSORS PARCEL NUMBERS: 20018034, -37, -39, -42, -43, -44, -17, -16, -40, -41, -35, 20014031
NUMBER OF STORIES: NOT APPLICABLE TO THE SOLAR ARRAYS
ZONING CODE 1: PD
SPRINKLERS: NO SPRINKLERS PROVIDED FOR THE ARRAYS (PER 903.3.1.1.1, EXCEPTION 7)

NEW ARRAY AREAS:

ARRAY 1:	5848 SF
ARRAY 2:	4938 SF
ARRAY 3:	5848 SF
ARRAY 4:	5848 SF
ARRAY 5:	5848 SF
ARRAY 6:	5848 SF

TOTAL NEW ARRAYS: 34,178 SF
TOTAL SITE AREA (MULTIPLE PARCELS): 800,633 SF

TOTAL PARKING (EXISTING): 489 STANDARD SPACES
31 ACCESSIBLE SPACES

TOTAL PARKING (AFTER SOLAR INSTALLATION): NO CHANGE

APPLICABLE BUILDING CODES:

- 2016 CALIFORNIA BUILDING CODE
- 2016 CALIFORNIA FIRE CODE
- 2016 CALIFORNIA ELECTRICAL CODE
- 2016 CALIFORNIA GREEN BUILDING CODE

CODE COMPLIANCE NOTES

ALLOWABLE AREA CALCULATIONS AS IT PERTAINS TO SOLAR ARRAYS:

SECTION 503.1, EXCEPTION 3, PART 1:
COMPLIANCE IS SHOWN: EACH SOLAR ARRAY IS LESS THAN 40'X150', ARE A MINIMUM OF 10' APART FROM EACH OTHER, AND HAVE DRIVE AISLES WHERE FIRE ACCESS IS REQUIRED AT A MINIMUM WIDTH OF 25'. THE SOLAR PHOTOVOLTAIC STRUCTURES ARE ONLY USED FOR PARKING PURPOSES. ALL SIDES ARE OPEN WITH NO INTERIOR PARTITIONS.

SECTION 602.1:
COMPLIANCE IS SHOWN: NO FIRE RESISTANCE IS REQUIRED FOR THE NEW SOLAR ARRAYS AS ALL REQUIREMENTS OF EXCEPTION 3 ARE MET.

VICINITY MAP



SEE SHEET A1.0

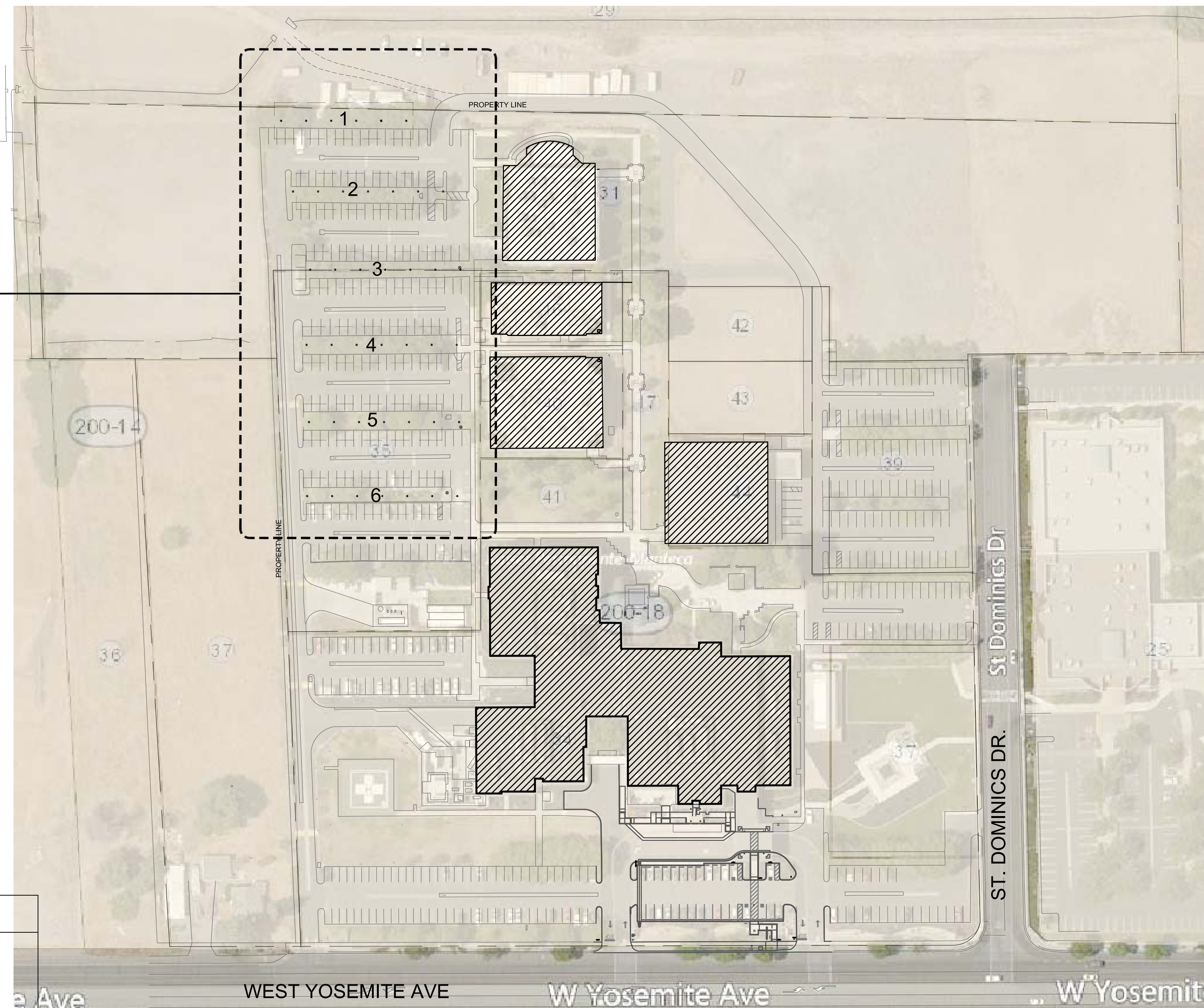

OVERALL SITE PLAN

SCALE: 1" = 80'-0"

SCOPE OF WORK

THIS PROJECT SCOPE INCLUDES THE INSTALLATION A GRID-TIED SOLAR PHOTOVOLTAIC SYSTEM.

THE INSTALLATION CONSISTS OF CARPORT MOUNTED ARRAYS, STRING INVERTERS, AND RELATED ELECTRICAL METERING AND SAFETY EQUIPMENT. ALL EQUIPMENT WILL BE INSTALLED AS REQUIRED BY APPLICABLE CODES AND THE LOCAL UTILITY COMPANY.

DURING DAYLIGHT HOURS, THIS PHOTOVOLTAIC SYSTEM WILL PROVIDE ELECTRICITY IN PARALLEL WITH THE LOCAL UTILITY SERVICE PROVIDER.

2100 west 15th street
tempe, arizona 85281-6942
tel: 480.285.3800
fax: 480.285.3801

adm

nrg
AMERESCO
Green • Clean • Sustainable

CN4901
MANTECA HOSPITAL
1777 WEST YOSEMITE AVENUE
MANTECA, CALIFORNIA 95337
KAISER PERMANENTE PV SOLAR PROJECT

Revisions

Project Number: 5954-100B0.10
Date: 6.16.17
Drawn By: BA
Checked By: JW

COVER SHEET
A0.0