

NOTES:
 COMPLETE SITE IMPROVEMENT PLANS SHALL BE PREPARED BY OTHERS.

FOR ALL GRADING, DRAINAGE, WATER, SEWER, FIRE SERVICE, ETC.

SEE PLANS PREPARED BY:
 G.M. ENGINEERING
 14425 SYLVAN ST.
 VAN NUYS, CA 91401

FOR ALL STREET IMPROVEMENTS, PAVING, SIDEWALKS, CURBS,
 GUTTERS, COMPLETE SITE DIMENSIONING, ETC. SEE PLANS BY:
 SUKOW ENGINEERING
 13266 CANTARA ST.
 NORTH HOLLYWOOD, CA 91605

SEE PLANS BY OTHERS FOR ALL LANDSCAPING, IRRIGATION, ETC.

NOTE:
 SITE DEVELOPMENT SHALL COMPLY WITH ALL CITY OF
 MANTECA STANDARDS AND WITH ALL CONDITIONS IMPOSED BY
 CITY OF MANTECA SITE PLAN REVIEW NO. SP-93-1

PARKING TABULATION

1. 9' x 18' TYP STALL - STRIPED W/ 4" PAINTED WHITE LINES.
 PROVIDED PARKING
 EXISTING = 35 9' x 18' STALLS + 2 H.C. STALLS
 EXIST. TOTAL = 37
 NEW = 322 9' x 18' STALLS + 6 H.C. STALLS
 TOTAL PROVIDED = 365 STALLS (INC. 3 H.C.)
 TOTAL REQ'D. = 251 STALLS (INC. 3 H.C.)

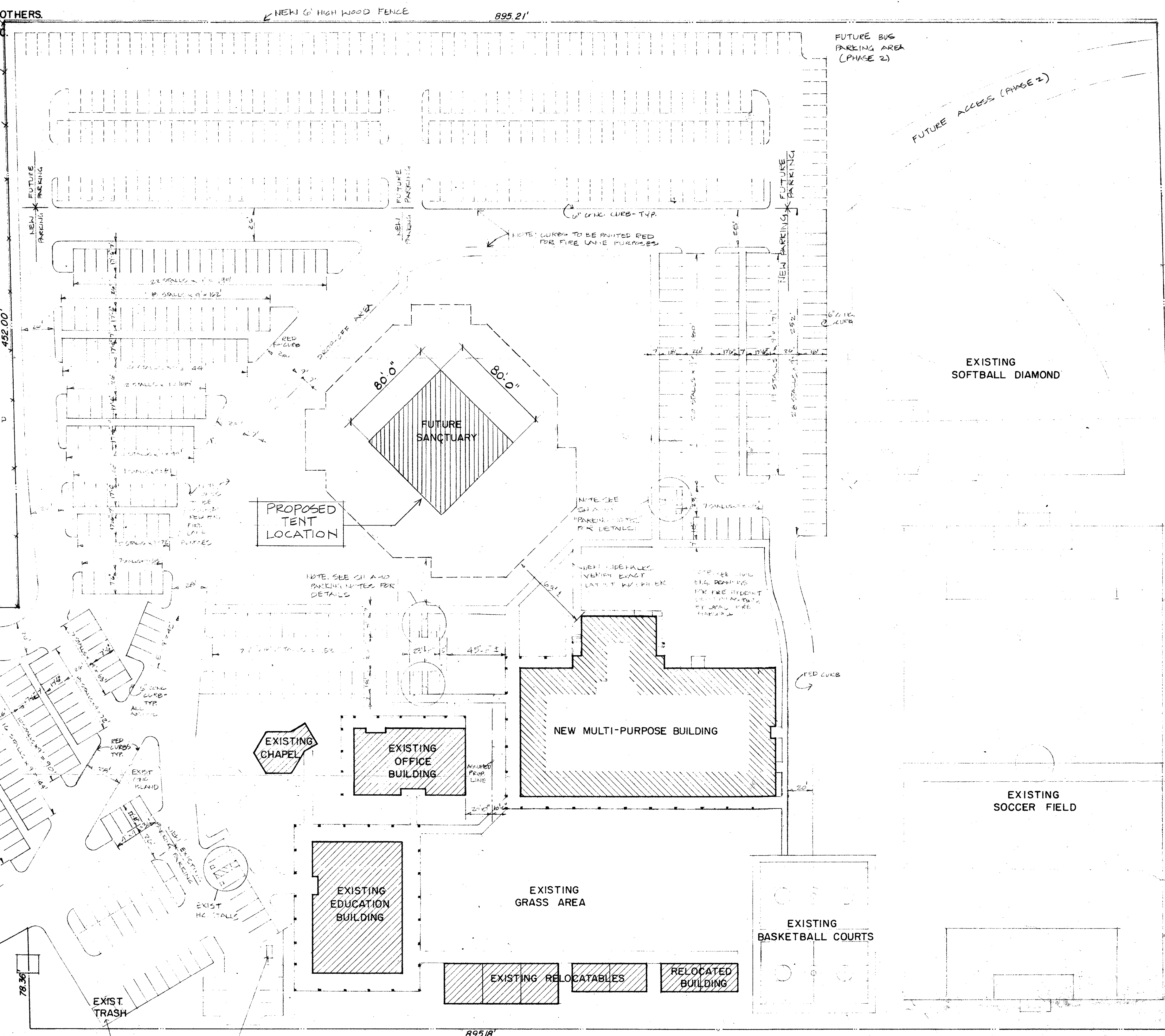

NOTE 1: A FIRE DEPT. APPROVED KEY LOCK BOX SHALL BE INSTALLED AT OR NEAR THE MAIN ENTRANCE/EXIT TO THE FACILITY. BOX SHALL CONTAIN APPROPRIATE KEYS TO ASSURE EMERGENCY ACCESS TO ALL SERVICE AREAS OF THE FACILITY. CONTACT THE CITY OF MANTECA FIRE PREVENTION DIVISION FOR SPECIFIC DETAILS, REQUIREMENTS, AND LOCATIONS.
 2. ALL RED CURBS, DENOTING EMERGENCY VEHICLE ACCESS LANES (SEE PLAN) SHALL HAVE THE PHRASE "NO PARKING-FIRE LANE" STENCILLED IN WHITE LETTERS AT 25' - 0" oc.

SITE PLAN
 SCALE: 1" = 40' - 0"

MULTI-PURPOSE BUILDING for FIRST ASSEMBLY of GOD CHURCH
 486 BUTTON AVE., MANTECA, CA

edward charles merlo, a.l.a., architect
 165 W. CLEVELAND STREET, STOCKTON, CALIFORNIA
 DATE: 9-20-93/REV: 1-10-94
 DRAWN BY: [Signature]

