



CITY OF  
**MANTECA**

INFORMATION TECHNOLOGY DIVISION | GEOGRAPHIC INFORMATION SYSTEMS | [WWW.CI.MANTECA.CA.US](http://WWW.CI.MANTECA.CA.US) | PHN: 209-456-8811

April 5, 2016

PULTE HOME CORP  
6210 STONERIDGE MALL RD, 5TH FL  
PLEASANTON, CA 94588

Re: NEW CITY ADDRESSES – UNION RANCH UNIT NO. 8 SUBDIVISION

The following addresses have been assigned to the parcels at UNION RANCH UNIT NO 8. Please see the attached map for reference.

| APN      | ADDRESS               | CITY    | STATE | ZIP   |
|----------|-----------------------|---------|-------|-------|
| 20435001 | 1516 CHESTNUT HILL DR | MANTECA | CA    | 95336 |
| 20435002 | 1498 CHESTNUT HILL DR | MANTECA | CA    | 95336 |
| 20435003 | 1492 CHESTNUT HILL DR | MANTECA | CA    | 95336 |
| 20435004 | 1480 CHESTNUT HILL DR | MANTECA | CA    | 95336 |
| 20435005 | 1468 CHESTNUT HILL DR | MANTECA | CA    | 95336 |
| 20435006 | 1456 CHESTNUT HILL DR | MANTECA | CA    | 95336 |
| 20435007 | 1461 CHESTNUT HILL DR | MANTECA | CA    | 95336 |
| 20435008 | 1467 CHESTNUT HILL DR | MANTECA | CA    | 95336 |
| 20435009 | 1475 CHESTNUT HILL DR | MANTECA | CA    | 95336 |
| 20435010 | 1481 CHESTNUT HILL DR | MANTECA | CA    | 95336 |
| 20435011 | 1487 CHESTNUT HILL DR | MANTECA | CA    | 95336 |
| 20435012 | 1493 CHESTNUT HILL DR | MANTECA | CA    | 95336 |
| 20435013 | 1517 CHESTNUT HILL DR | MANTECA | CA    | 95336 |
| 20435014 | 1541 CHESTNUT HILL DR | MANTECA | CA    | 95336 |
| 20435015 | 1550 ARBOR BROOK DR   | MANTECA | CA    | 95336 |
| 20435016 | 1532 ARBOR BROOK DR   | MANTECA | CA    | 95336 |
| 20435017 | 1512 ARBOR BROOK DR   | MANTECA | CA    | 95336 |
| 20435018 | 1494 ARBOR BROOK DR   | MANTECA | CA    | 95336 |
| 20435019 | 1490 ARBOR BROOK DR   | MANTECA | CA    | 95336 |
| 20435020 | 1484 ARBOR BROOK DR   | MANTECA | CA    | 95336 |
| 20435021 | 1478 ARBOR BROOK DR   | MANTECA | CA    | 95336 |
| 20435022 | 1472 ARBOR BROOK DR   | MANTECA | CA    | 95336 |
| 20435023 | 1466 ARBOR BROOK DR   | MANTECA | CA    | 95336 |
| 20435024 | 1460 ARBOR BROOK DR   | MANTECA | CA    | 95336 |
| 20435025 | 1455 ARBOR BROOK DR   | MANTECA | CA    | 95336 |
| 20435026 | 1461 ARBOR BROOK DR   | MANTECA | CA    | 95336 |
| 20435027 | 1469 ARBOR BROOK DR   | MANTECA | CA    | 95336 |

| APN      | ADDRESS              | CITY    | STATE | ZIP   |
|----------|----------------------|---------|-------|-------|
| 20435028 | 1473 ARBOR BROOK DR  | MANTECA | CA    | 95336 |
| 20435029 | 1479 ARBOR BROOK DR  | MANTECA | CA    | 95336 |
| 20435030 | 1485 ARBOR BROOK DR  | MANTECA | CA    | 95336 |
| 20435031 | 1491 ARBOR BROOK DR  | MANTECA | CA    | 95336 |
| 20435032 | 2964 CLEAR POINT WAY | MANTECA | CA    | 95336 |
| 20435033 | 2976 CLEAR POINT WAY | MANTECA | CA    | 95336 |
| 20435034 | 2988 CLEAR POINT WAY | MANTECA | CA    | 95336 |
| 20435035 | 2992 CLEAR POINT WAY | MANTECA | CA    | 95336 |
| 20435036 | 1537 RIVER BIRCH ST  | MANTECA | CA    | 95336 |
| 20435037 | 1541 RIVER BIRCH ST  | MANTECA | CA    | 95336 |
| 20435038 | 1547 RIVER BIRCH ST  | MANTECA | CA    | 95336 |
| 20435039 | 1555 RIVER BIRCH ST  | MANTECA | CA    | 95336 |
| 20435040 | 1569 RIVER BIRCH ST  | MANTECA | CA    | 95336 |
| 20435041 | 1577 RIVER BIRCH ST  | MANTECA | CA    | 95336 |
| 20435042 | 1589 RIVER BIRCH ST  | MANTECA | CA    | 95336 |
| 20435043 | 1611 RIVER BIRCH ST  | MANTECA | CA    | 95336 |
| 20435044 | 1625 RIVER BIRCH ST  | MANTECA | CA    | 95336 |
| 20435045 | 1643 RIVER BIRCH ST  | MANTECA | CA    | 95336 |
| 20435046 | 1665 RIVER BIRCH ST  | MANTECA | CA    | 95336 |
| 20435047 | 1681 RIVER BIRCH ST  | MANTECA | CA    | 95336 |
| 20435048 | 2991 COTTON BRIAR LN | MANTECA | CA    | 95336 |
| 20435049 | 2985 COTTON BRIAR LN | MANTECA | CA    | 95336 |
| 20435050 | 2979 COTTON BRIAR LN | MANTECA | CA    | 95336 |
| 20435051 | 2973 COTTON BRIAR LN | MANTECA | CA    | 95336 |
| 20435052 | 2965 COTTON BRIAR LN | MANTECA | CA    | 95336 |
| 20435053 | 2957 COTTON BRIAR LN | MANTECA | CA    | 95336 |
| 20435054 | 2951 COTTON BRIAR LN | MANTECA | CA    | 95336 |
| 20435055 | 2943 COTTON BRIAR LN | MANTECA | CA    | 95336 |
| 20435056 | 2935 COTTON BRIAR LN | MANTECA | CA    | 95336 |
| 20435057 | 2927 COTTON BRIAR LN | MANTECA | CA    | 95336 |
| 20435058 | 2930 COTTON BRIAR LN | MANTECA | CA    | 95336 |
| 20435059 | 2942 COTTON BRIAR LN | MANTECA | CA    | 95336 |
| 20435060 | 2950 COTTON BRIAR LN | MANTECA | CA    | 95336 |
| 20435061 | 2956 COTTON BRIAR LN | MANTECA | CA    | 95336 |
| 20435062 | 2962 COTTON BRIAR LN | MANTECA | CA    | 95336 |
| 20435063 | 2970 COTTON BRIAR LN | MANTECA | CA    | 95336 |
| 20435064 | 1644 RIVER BIRCH ST  | MANTECA | CA    | 95336 |
| 20435065 | 1626 RIVER BIRCH ST  | MANTECA | CA    | 95336 |
| 20435066 | 1612 RIVER BIRCH ST  | MANTECA | CA    | 95336 |
| 20435067 | 1590 RIVER BIRCH ST  | MANTECA | CA    | 95336 |

| APN      | ADDRESS               | CITY    | STATE | ZIP   |
|----------|-----------------------|---------|-------|-------|
| 20435068 | 1578 RIVER BIRCH ST   | MANTECA | CA    | 95336 |
| 20435069 | 1570 RIVER BIRCH ST   | MANTECA | CA    | 95336 |
| 20435070 | 1556 RIVER BIRCH ST   | MANTECA | CA    | 95336 |
| 20435071 | 1548 RIVER BIRCH ST   | MANTECA | CA    | 95336 |
| 20435072 | 2979 CLEAR POINT WAY  | MANTECA | CA    | 95336 |
| 20435073 | 2961 CLEAR POINT WAY  | MANTECA | CA    | 95336 |
| 20435074 | 1565 ARBOR BROOK DR   | MANTECA | CA    | 95336 |
| 20435075 | 1577 ARBOR BROOK DR   | MANTECA | CA    | 95336 |
| 20435076 | 1589 ARBOR BROOK DR   | MANTECA | CA    | 95336 |
| 20435077 | 1607 ARBOR BROOK DR   | MANTECA | CA    | 95336 |
| 20435078 | 1613 ARBOR BROOK DR   | MANTECA | CA    | 95336 |
| 20436001 | 1680 CHESTNUT HILL DR | MANTECA | CA    | 95336 |
| 20436002 | 1674 CHESTNUT HILL DR | MANTECA | CA    | 95336 |
| 20436003 | 1662 CHESTNUT HILL DR | MANTECA | CA    | 95336 |
| 20436004 | 1650 CHESTNUT HILL DR | MANTECA | CA    | 95336 |
| 20436005 | 1638 CHESTNUT HILL DR | MANTECA | CA    | 95336 |
| 20436006 | 1622 CHESTNUT HILL DR | MANTECA | CA    | 95336 |
| 20436007 | 1610 CHESTNUT HILL DR | MANTECA | CA    | 95336 |
| 20436008 | 1570 CHESTNUT HILL DR | MANTECA | CA    | 95336 |
| 20436009 | 1544 CHESTNUT HILL DR | MANTECA | CA    | 95336 |
| 20436010 | 1563 CHESTNUT HILL DR | MANTECA | CA    | 95336 |
| 20436011 | 1585 CHESTNUT HILL DR | MANTECA | CA    | 95336 |
| 20436012 | 1607 CHESTNUT HILL DR | MANTECA | CA    | 95336 |
| 20436013 | 1615 CHESTNUT HILL DR | MANTECA | CA    | 95336 |
| 20436014 | 1623 CHESTNUT HILL DR | MANTECA | CA    | 95336 |
| 20436015 | 1631 CHESTNUT HILL DR | MANTECA | CA    | 95336 |
| 20436016 | 1643 CHESTNUT HILL DR | MANTECA | CA    | 95336 |
| 20436017 | 1655 CHESTNUT HILL DR | MANTECA | CA    | 95336 |
| 20436018 | 1667 CHESTNUT HILL DR | MANTECA | CA    | 95336 |
| 20436019 | 1671 CHESTNUT HILL DR | MANTECA | CA    | 95336 |
| 20436020 | 1679 CHESTNUT HILL DR | MANTECA | CA    | 95336 |
| 20436021 | 1683 CHESTNUT HILL DR | MANTECA | CA    | 95336 |
| 20436022 | 1680 ARBOR BROOK DR   | MANTECA | CA    | 95336 |
| 20436023 | 1672 ARBOR BROOK DR   | MANTECA | CA    | 95336 |
| 20436024 | 1664 ARBOR BROOK DR   | MANTECA | CA    | 95336 |
| 20436025 | 1658 ARBOR BROOK DR   | MANTECA | CA    | 95336 |
| 20436026 | 1650 ARBOR BROOK DR   | MANTECA | CA    | 95336 |
| 20436027 | 1640 ARBOR BROOK DR   | MANTECA | CA    | 95336 |
| 20436028 | 1634 ARBOR BROOK DR   | MANTECA | CA    | 95336 |
| 20436029 | 1628 ARBOR BROOK DR   | MANTECA | CA    | 95336 |

To ensure that the City of Manteca Police and Fire staff can provide you with the highest level of service and protection, addresses on your structures shall comply with the following California Fire Code:

SECTION 505 PREMISES IDENTIFICATION - 505.1 Address numbers. New and existing buildings shall have approved address numbers, building numbers or approved building identification placed in a position that is plainly legible and visible from the street or road fronting the property. These numbers shall contrast with their background. Address numbers shall be Arabic numerals or alphabet letters. Numbers shall be a minimum of 4 inches (102 mm) high with a minimum stroke width of 0.5 inch (12.7 mm).

The agencies below have been notified of these new addresses. Please contact me at [jdavis@mantecagov.com](mailto:jdavis@mantecagov.com) or (209) 456-8811 should you have any questions.

Sincerely,



Pennie Arounsack | GIS Analyst  
Information Technology Division  
1001 W Center St, Manteca, CA 95337  
Phone: 209-456-8811 | Fax: 209-923-8988  
[www.ci.manteca.ca.us](http://www.ci.manteca.ca.us)

Attachment: Map Exhibit

Cc: City of Manteca – City Clerk, Public Works, Police, Fire, Finance, and Community Development  
San Joaquin County Communications (911 Coordinator)      Manteca Ambulance Service  
San Joaquin County Registrar of Voters      Comcast  
San Joaquin County Community Development      Verizon  
Pacific Gas & Electric Company      State Board of Equalization  
Manteca Unified School District      San Joaquin County Assessor  
Manteca-Lathrop Fire District      U.S. Post Office – Manteca95336/95337  
Stockton Fire Dispatch      South San Joaquin Irrigation District

**MANTECA**

1012 NEW CITY ADDRESS

1007 CITY ADDRESS

UNION RANCH UNIT NO. 8 PARCELS

PARCELS

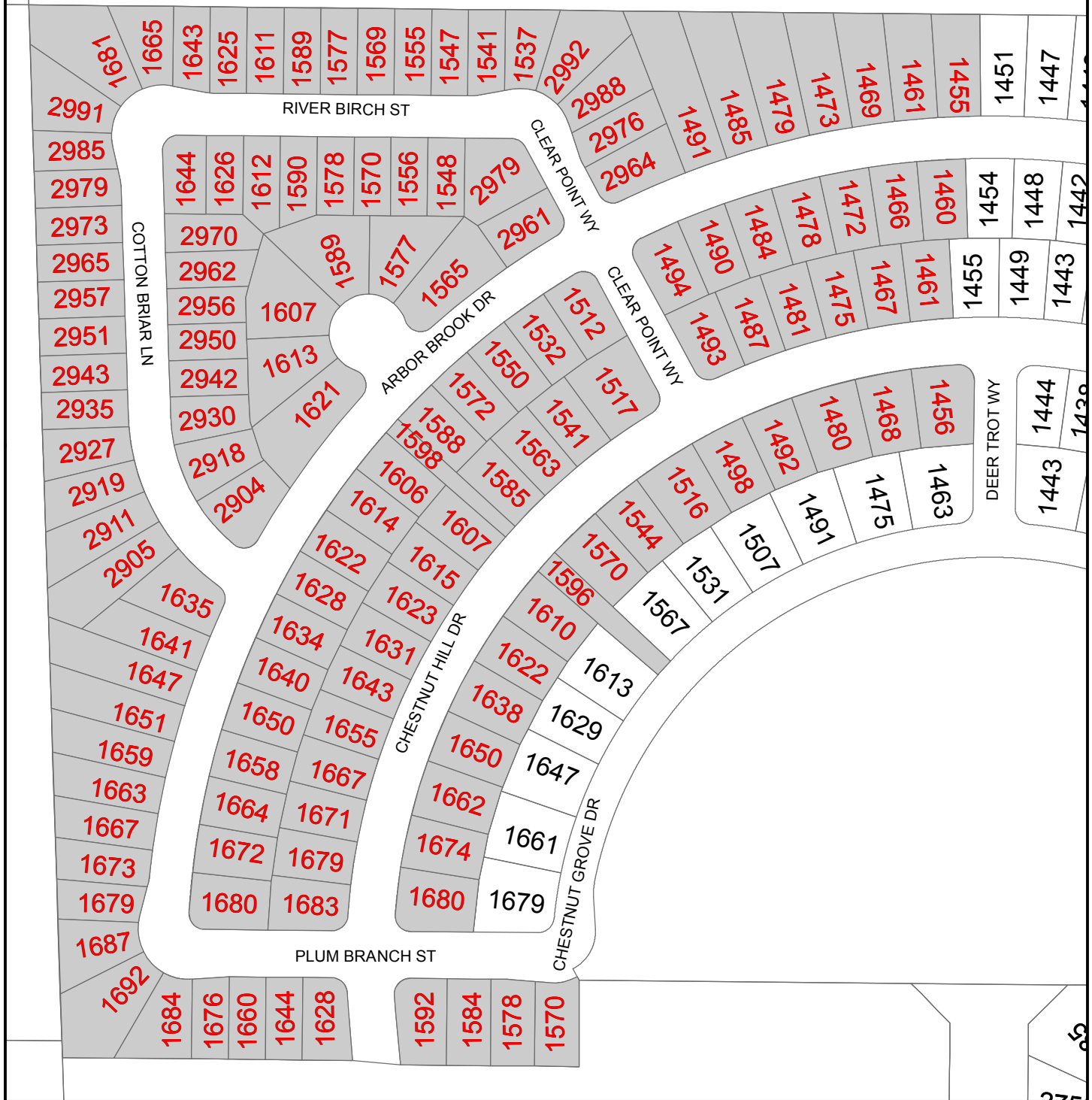

**NEW CITY ADDRESSES - UNION RANCH UNIT NO. 8  
APRIL 2016**

CITY OF MANTECA  
1001 W. CENTER STREET  
MANTECA, CA 95337

Data on this map is intended for general use and informational purposes only. The City of Manteca does not warrant the accuracy, quality, or completeness of data or suitability for any particular purpose. Information on this map is not intended to replace engineering, survey, or other primary research methods.

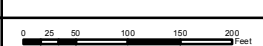

PARCNUMACK 4/5/2016  
\\flopaga\Documents\Addresses\2015  
UnionRanch\_UnitNo8\UnionRanch\_UnitNo8.mxd